

YGVF 系列辊道用变频调速三相异步电动机

YGVF SERIES CONVERTER ADJUSTABLE SPEED FOR ROLLER TABLE INDUCTION MOTORS

机座号 100~225

功率 0.3~132kW

防护等级 IP54

绝缘等级 F, H



适用于: 冶金行业特别是冶金行业中辊道设备在变频控制条件下, 电动机既适合于 S1 连续工作制运行的输送辊道辊子, 也特别适合于短时或断续周期运行、频繁启动、制动和正、反转运行的工作辊道辊子。

Applications: widely used for the metallurgy equipment, especially for transporting roller bed on continuous duty and working roller bed with short time on duty where frequent starting, braking and reversing running is existed.

特点: 过载能力大、机械强度高, 调速范围广、运行稳定

Features: ability of overload and mechanic strength. Wide range of speed and running smoothly.

性能数据 Performance Data

380V 50Hz

型 号 Type	功 率 kW	额定电流 Current A	额定转矩 Rated Torque N • m	转 速 r/min	堵转转矩 额定转矩 Locked-rotor Torque Rated Torque	最大转矩 额定转矩 Breakdown Torque Rated Torque	转动惯量 kg. m ²
50Hz 时 同步转速 1500r/min							
YGVF100L-4	0.75	1.8	5	1440	1.3~2.0	3.7	0.0092
YGVF112L1-4	1.1	2.4	7.3	1450	1.3~2.0	3.6	0.0124
YGVF112L2-4	1.5	3.0	10	1450	1.3~2.0	3.6	0.0173
YGVF132M1-4	2.2	4.6	14.5	1450	1.3~2.0	3.5	0.0254
YGVF132M2-4	3	6.1	20	1450	1.3~2.0	3.5	0.0382
YGVF160S1-4	4	8.0	26.2	1460	1.3~2.0	3.6	0.0785
YGVF160S2-4	5.5	11	36	1460	1.3~2.0	3.6	0.0826
YGVF160L1-4	6.3	12.3	41.2	1460	1.3~2.0	3.7	0.102
YGVF160L2-4	7.5	14.5	49.1	1460	1.3~2.0	3.7	0.125
YGVF180L1-4	9	17.0	58.7	1465	1.3~2.0	3.7	0.152
YGVF180L2-4	11	20.5	71.7	1465	1.3~2.0	3.7	0.178
YGVF200L1-4	15	28.0	97.8	1465	1.3~2.0	3.8	0.265
YGVF200L2-4	18.5	33.4	120.6	1465	1.3~2.0	3.8	0.356
YGVF225M1-4	22	39.6	142.5	1475	1.3~2.0	3.8	0.411
YGVF225M2-4	25	44.5	162	1475	1.3~2.0	3.7	0.483
50Hz 时同步转速 1000r/min							
YGVF112L1-6	0.75	2.0	7.4	965	1.3~2.0	3.6	0.0112

型 号 Type	功 率 kW	额定电流 Current A	额定转矩 Rated Torque N • m	转 速 r/min	堵转转矩 额定转矩	最大转矩 额定转矩	转动惯量 kg. m ²
					Locked-rotor Torque Rated Torque	Breakdown Torque Rated Torque	
50Hz 时同步转速 1000r/min							
YGVF112L2-6	1.1	2.7	11	965	1.3~2.0	3.6	0.0116
YGVF132M1-6	1.5	3.4	15	965	1.3~2.0	3.2	0.0264
YGVF132M2-6	2.2	4.8	22	965	1.3~2.0	3.2	0.0426
YGVF160S1-6	3	6.6	29.5	970	1.3~2.0	3.4	0.0857
YGVF160S2-6	4	8.7	39.4	970	1.3~2.0	3.4	0.0934
YGVF160L1-6	5.5	11.7	54	970	1.3~2.0	3.6	0.115
YGVF160L2-6	6.3	13.2	62	970	1.3~2.0	3.5	0.159
YGVF180L1-6	7.5	15.0	73.5	975	1.3~2.0	3.6	0.203
YGVF180L2-6	9	17.7	88.1	975	1.3~2.0	3.6	0.287
YGVF200L1-6	11	21.7	107.8	975	1.3~2.0	3.7	0.312
YGVF200L2-6	15	28.6	147	975	1.3~2.0	3.7	0.383
YGVF225M1-6	18.5	34.4	181	975	1.3~2.0	3.5	0.524
YGVF225M2-6	22	41.0	215	975	1.3~2.0	3.5	0.623
50Hz 时同步转速 750r/min							
YGVF112L1-8	0.55	1.6	7.3	725	1.3~2.0	3.5	0.0112
YGVF112L2-8	0.75	2.0	10	725	1.3~2.0	3.5	0.0166
YGVF132M1-8	1.1	3.2	14.5	725	1.3~2.0	3.2	0.0264
YGVF132M2-8	1.5	4.3	20	725	1.3~2.0	3.2	0.0426
YGVF160S1-8	2.2	5.5	30	725	1.3~2.0	3.5	0.0857
YGVF160S2-8	3	7.3	39.5	725	1.3~2.0	3.5	0.0945
YGVF160L1-8	4	9.6	52.7	725	1.3~2.0	3.6	0.121
YGVF160L2-8	5.5	13.0	72.5	725	1.3~2.0	3.6	0.196
YGVF180L1-8	6.3	15.0	82.4	730	1.3~2.0	3.6	0.238
YGVF180L2-8	7.5	17.0	98	730	1.3~2.0	3.5	0.297
YGVF200L1-8	9	20.0	117.7	730	1.3~2.0	3.6	0.315
YGVF200L2-8	11	25.0	144	730	1.3~2.0	3.7	0.341
YGVF225M1-8	15	31.7	195	735	1.3~2.0	3.6	0.524
YGVF225M2-8	18.5	38.5	240	735	1.3~2.0	3.6	0.623

注：表中堵转转矩/额定转矩为 3Hz 时的值，其大小与变频器的控制方式有关。最大转矩/额定转矩为 50Hz 时的值。
The ratio of the locked-torque/rated torque is the value at 3Hz, which is determined by the control mode of the inverter. The ratio of the breakdown/rated torque is the value at 50Hz.

主要技术特性 Technical Performance

电动机的绝缘等级为 F 或 H 级，外壳防护等级为 IP54（防尘、防溅水），也可根据需要制成 IP55、IP56，冷却方式为 IC410（全封闭表面冷却）。电动机的调速范围广，变频范围为 5~100Hz，其中 5~50Hz 为恒转矩调速，55~100Hz 为恒功率调速。电动机的过载能力大，过载能力可达到额定转矩的 3.5~4.0 倍（一般电动机为 2.0 倍）。

低频起动力矩大，频率为 5Hz 时的起动转矩可达到额定转矩的 1.3~1.8 倍。电动机低速性能好，低速时转矩平滑，无爬行、脉动现象。

The motor designed with F or H insulation, IP54 protection. The frequency range of the motor is 5~100Hz, maintaining torque constant during 5~50Hz and output constant during 50~100Hz. The overload capability of the motor is excellent. The motor can be operated with the overload of 3.5~4.0 times of the rated torque (the ration of the general purpose motor is about 2). Motors have good performance at low speed. The starting torque at 5Hz is 1.3~1.8 times of the rated values.

外形及安装尺寸 Dimensions

mm

B3

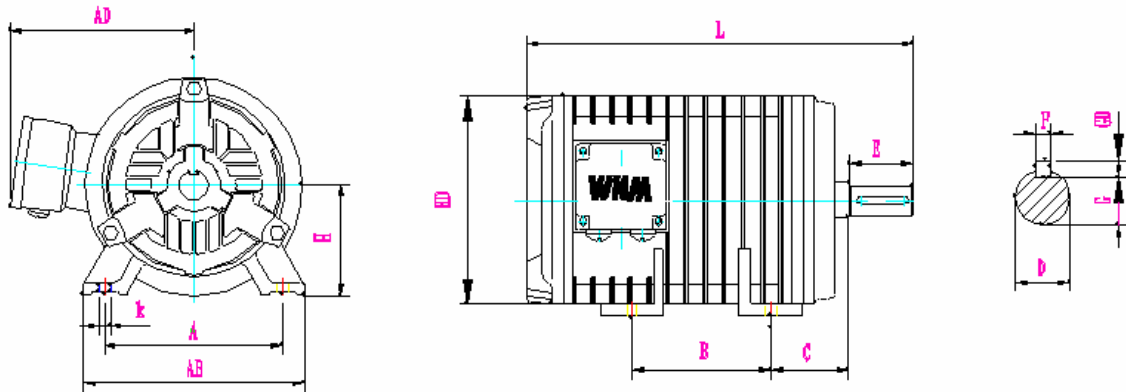

YGVF112-YGVF225

机座号 Frame	安 装 尺 寸 Mounting Dimension										外 形 尺 寸 Overall Dimension							
	A	B	C	D	E	F	G	GD	H	K	AB	AD	AE	BB	HA	HD	HE	L
100L	160	140	63	φ28j6	60	8	24	7	100	12	200	180	220	180	18	205	—	310
112L	190	159	70	φ32k6	80	10	27	8	112	12	245	205	240	205	20	240	—	445
132M	216	178	89	φ38k6	80	10	33	8	132	12	265	220	265	225	22	265	—	500
160S	254	178	108	φ48k6	110	14	42.5	9	160	15	315	220	340	230	27	325	—	565
160L	254	254	108	φ48k6	110	14	42.5	9	160	15	315	220	340	320	27	325	—	685
180L	279	279	121	φ55m6	110	16	49	10	180	15	360	260	370	350	28	365	—	710
200L	318	305	133	φ65m6	140	18	58	11	200	19	415	310	435	385	35	410	—	795
225M	356	311	149	φ75m6	140	20	67.5	12	225	19	470	315	475	395	36	455	—	840

B5

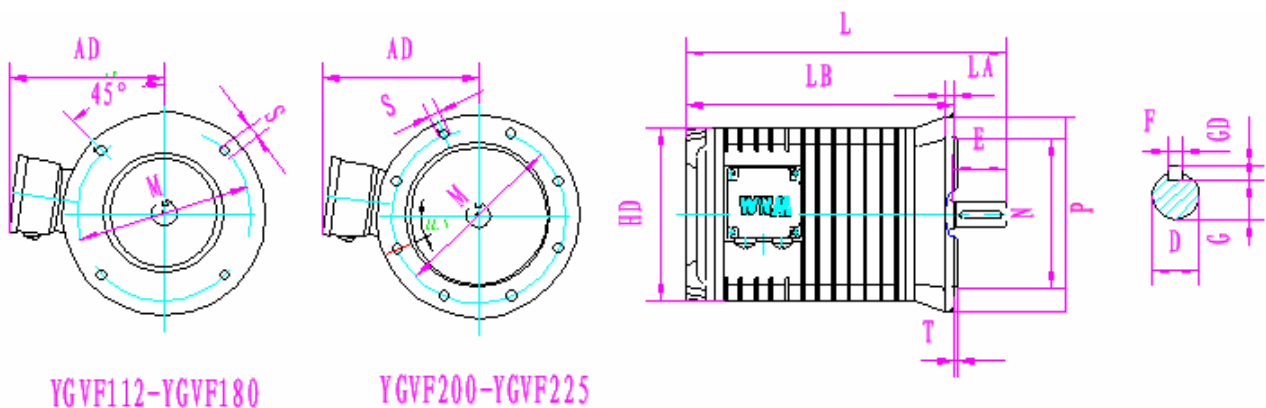

YGVF112-YGVF180

YGVF200-YGVF225

机座号 Frame	安 装 尺 寸 Mounting Dimension											外 形 尺 寸 Overall Dimension					
	D	E	F	G	GD	M	N	P	R	S	T	AD	AE	HD	LA	LB	L
100L	φ28j6	60	8	24	7	215	φ180j6	250	0	15	4	180	220	205	14	250	310
112M	φ32k6	80	10	27	8	215	φ180j6	250	0	15	4	205	240	240	15	365	445
132M	φ38k6	80	10	33	8	265	φ230j6	300	0	15	4	220	265	265	15	420	500
160S	φ48k6	110	14	42.5	9	300	φ250j6	350	0	19	5	220	340	325	15	455	565
160L	φ48k6	110	14	42.5	9	300	φ250j6	350	0	19	5	220	340	325	15	575	685
180L	φ55m6	110	16	49	10	300	φ250j6	350	0	19	5	260	370	365	18	600	710
200L	φ65m6	140	18	58	11	400	φ350j6	450	0	19	5	310	435	410	20	655	795
225M	φ75m6	140	20	67.5	12	400	φ350j6	450	0	19	4	315	475	455	22	700	840

常用的安装结构形式为 B3, B5 和 B35

The mounting arrangement is B3, B5 or B35.

外形及安装尺寸 Dimensions

mm

B35

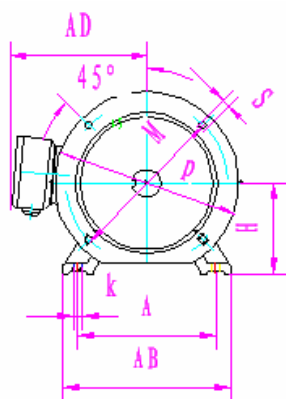

YGVF112-YGVF180

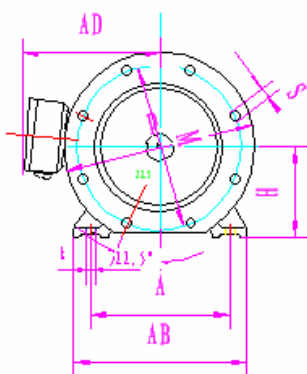

YGVF200-YGVF355

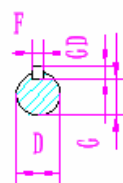
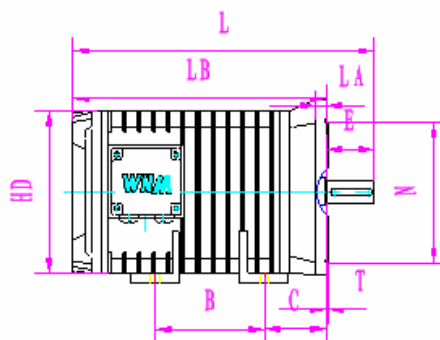

机座号 Frame	安 装 尺 寸 Mounting Dimension															外 形 尺 寸 Overall Dimension										
	A	B	C	D	E	F	G	H	M	N	P	R	S	T	K	AB	AD	AE	BB	HD	HA	HE	LA	LB	L	
100L	160	140	63	28	60	8	24	100	215	180	250	0	15	4	12	200	180	220	180	205	18	—	14	250	310	
112L	190	159	70	32	80	10	27	112	215	180	250	0	15	4	12	245	205	240	205	240	20	—	15	365	445	
132M	216	178	89	38	80	10	33	132	265	230	300	0	15	4	12	265	220	265	225	265	22	—	15	420	500	
160S	254	178	108	48	110	14	42.5	160	300	250	350	0	19	5	15	315	220	340	230	325	27	—	15	455	565	
160L	254	254	108	48	110	14	42.5	160	300	250	350	0	19	5	15	315	220	340	320	325	27	—	15	575	685	
180L	279	279	121	55	110	16	49	180	300	250	350	0	19	5	15	360	260	370	350	365	28	—	18	600	710	
200L	318	305	133	65	140	18	58	200	400	350	450	0	19	5	19	415	310	435	385	410	35	—	20	655	795	
225M	356	311	149	75	140	20	67.5	225	400	350	450	0	19	5	19	470	315	475	395	455	36	—	22	700	840	